

DRAWING No.
BL/D8337

THIRD ANGLE
PROJECTION

DO NOT
SCALE

USED ON BL/

STAINLESS STEEL MESH FILTER

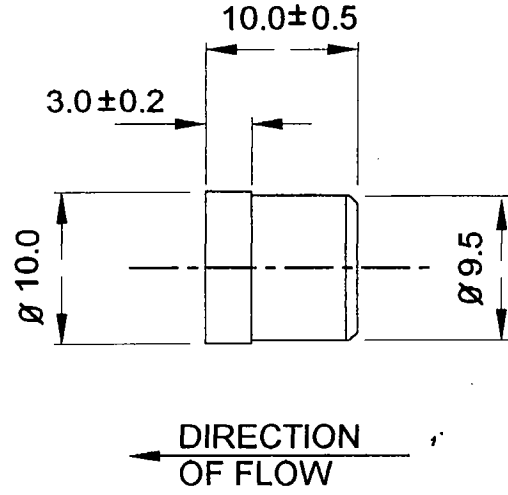
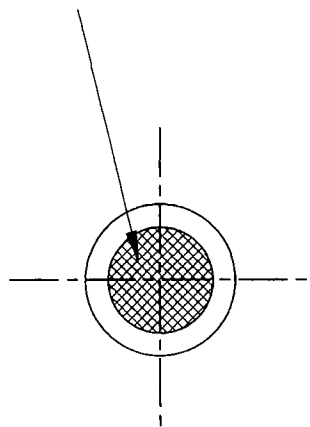

OPENING PRESSURE 7.0 - 10.5 KN/M²

FLOWRATE 28 LITRES/MIN @ 3.5KN/M²
ABOVE THE OPENING PRESSURE

MAX REVERSE FLOW 1CC/HR

SEAL INTO POSITION WITH A SUITABLE ADHESIVE



ACTUAL SIZE

MATERIAL	FINISH				
ALUMINIUM ALLOY	ANODISED				
EST.WEIGHT		ORIGINAL	1	2-7-99	
DIMNS IN MM.	SURFACE ROUGHNESS	CHANGE	MOD.No.	ISSUE	DATE
SCALE		TOLERANCES			
BROWNELL LIMITED, LONDON, NW10		DRAWN	NGH	CHECKED	GGH
TITLE	PRESSURE RELIEF VALVE (OUTWARDS) OPENING RELIEF PRESSURE 1 - 1.5 PSI	DRAWING No. BL/D8337 INST			

THIS DRAWING IS THE PROPERTY OF BROWNELL LIMITED AND MAY NOT BE COPIED OR REPRODUCED WITHOUT THEIR PRIOR WRITTEN PERMISSION